

Installation Manual

AS-3424
ARNOTT
NEW FRONT RIGHT AIR STRUT
2010-2016 MERCEDES-BENZ E-CLASS (W212)
2012-2017 CLS-CLASS (W218)
W/4MATIC, W/AIRM & ADS

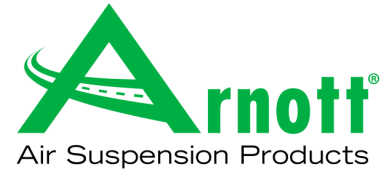

Congratulations on your purchase of an Arnott® air suspension product. We at Arnott Incorporated are proud to offer a high quality product at the industry's most competitive pricing. Thank you for your confidence in us and our product.

Proper installation is essential to experience and appreciate the benefits of this system. Please take a moment to review these installation instructions before you begin to install these components on your vehicle. The removal and installation of air suspension products should only be performed by a fully qualified, ASE Certified, professional.

It is equally important to be aware of all necessary safety measures while installing your new Air Suspension System. This includes proper lifting and immobilizing of the vehicle and isolation of any stored energy to prevent personal injury or property damage.

"Engineered to Ride, Built to Last®"



WARNING: *The air suspension system is under pressure (up to 10 bar, or 150 lbf/in). Verify pressure has been relieved and disconnect power to the air suspension system prior to disassembly. Do not allow dirt or grease to enter the system. Always wear standard hand, ear, and eye protection when servicing the air suspension system.*

Arnott® is committed to the quality of its products. If you have a question or problem with any Arnott product, please contact Arnott by calling **800-251-8993** during normal business hours or email techassistance@arnottinc.com. (In the EU please call +31 (0)73 7850 580 or email info@arnotteurope.com)

GENERAL INFORMATION:

Reading this manual signifies your agreement to the terms of the general release, waiver of liability, and hold harmless agreement, the full text of which is available at www.arnottinc.com.

- Not to be stored below 5°F (-15°C) or above 122°F (50°C).
- Avoid damage to air lines and cables.
- Removal and installation is only to be performed by fully qualified personnel.
- Use car manufacturer's diagnostic software.

CAUTION: *Damage to the vehicle and air suspension system can be incurred if work is carried out in a manner other than specified in the instructions or in a different sequence.*



To avoid the possibility of short circuits while working with electric components consult your owner's manual on how to disconnect your battery.



Consult your vehicle owner's manual, service manual, or car dealer for the correct jacking points on your vehicle and for additional care, safety and maintenance instructions. Under no circumstances should any work be completed underneath the vehicle if it is not adequately supported, as serious injuries and death can occur.

AIR STRUT REMOVAL

1. SET STEERING TO STRAIGHT AHEAD.
2. RAISE VEHICLE.
3. REMOVE THE RIGHT FRONT WHEEL. (FIGURE 1)



FIGURE 1

4. LOOSEN AND REMOVE THE AIR LINE FITTING FROM THE TOP OF THE STRUT. (FIGURES 2, 3)

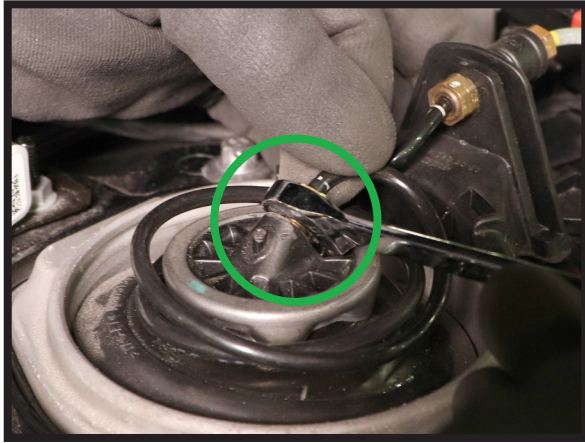

FIGURE 2

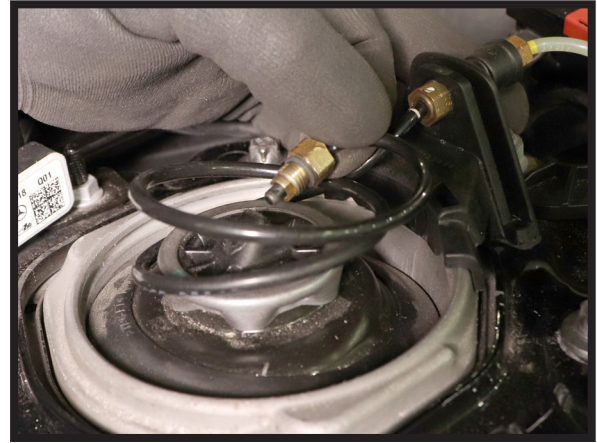

FIGURE 3

5. REMOVE THE AIR LINE FITTING. TO DO SO, SPREAD THE COLLET OPEN AND THE REMAINING FITTING WILL SLIDE OFF OF THE AIR HOSE. (FIGURES 4, 5)

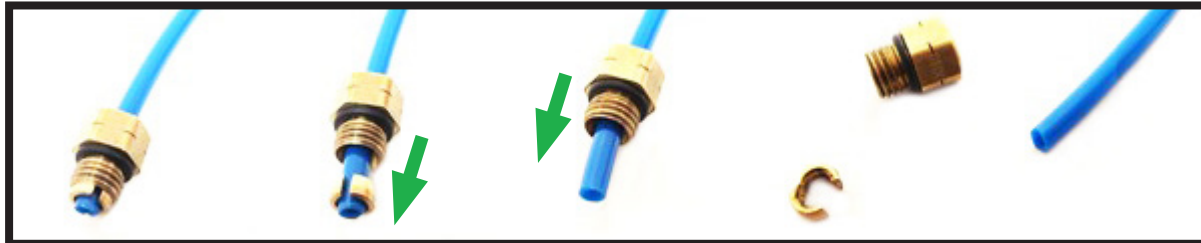

FIGURE 4

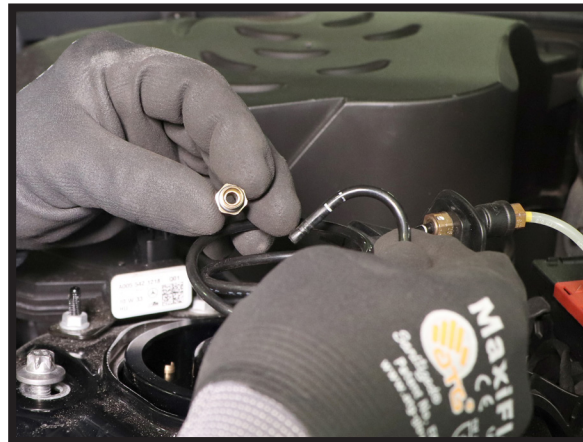

FIGURE 5

6. LOOSEN AND REMOVE THE THREE (3) TOP MOUNTING BOLTS. (FIGURES 6, 7)



FIGURE 6

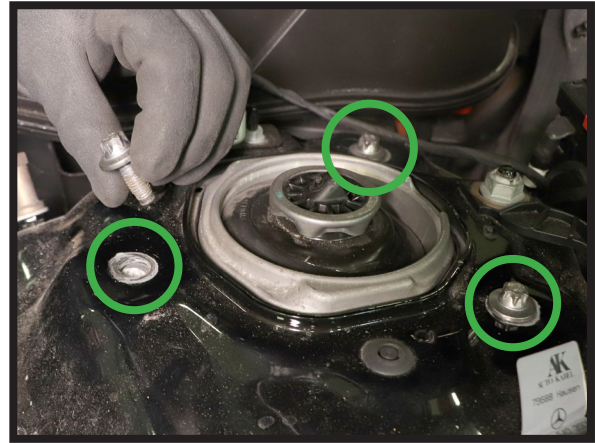

FIGURE 7

7. DISCONNECT ELECTRICAL CONNECTION ON THE BOTTOM MOUNT OF THE STRUT. (FIGURE 8)

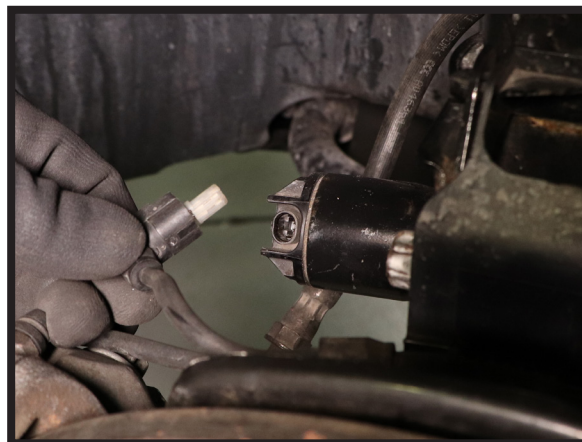

FIGURE 8

8. UNCLIP AND UNROUTE ELECTRICAL AND BRAKE LINES FROM THE STRUT WIRE MOUNTING BRACKET. (FIGURES 9, 10, 11)



FIGURE 9

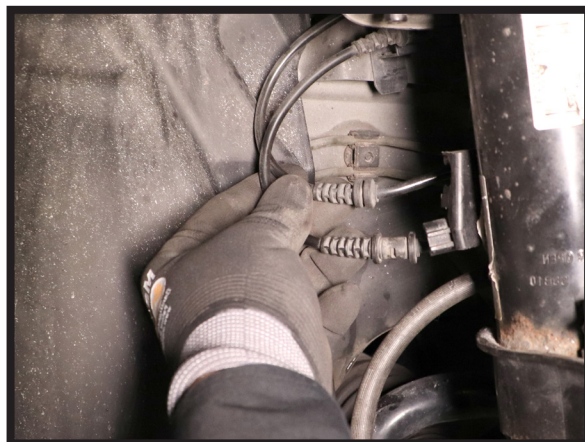

FIGURE 10

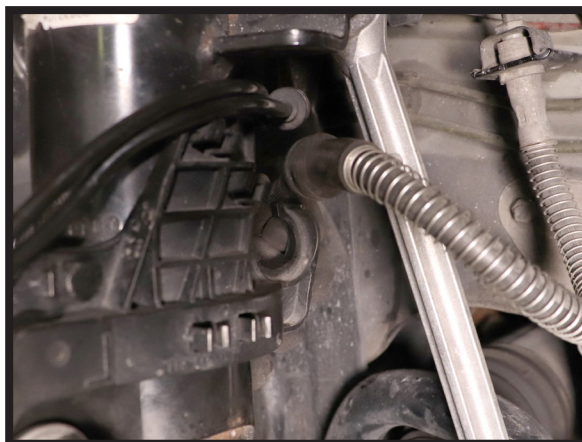

FIGURE 11

9. REMOVE THE STRUT WIRE MOUNTING BRACKET. THIS BRACKET WILL BE REUSED FOR INSTALLATION. (FIGURES 12, 13, 14)

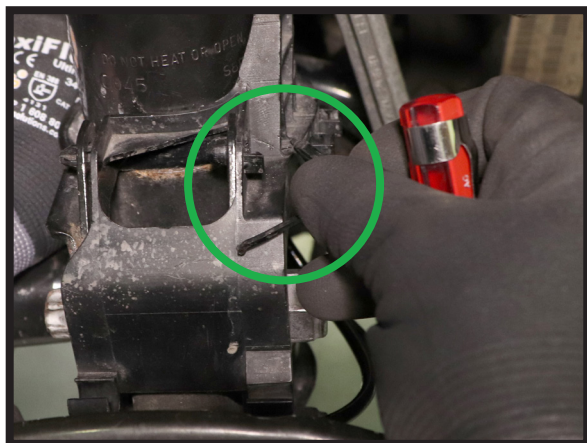

FIGURE 12

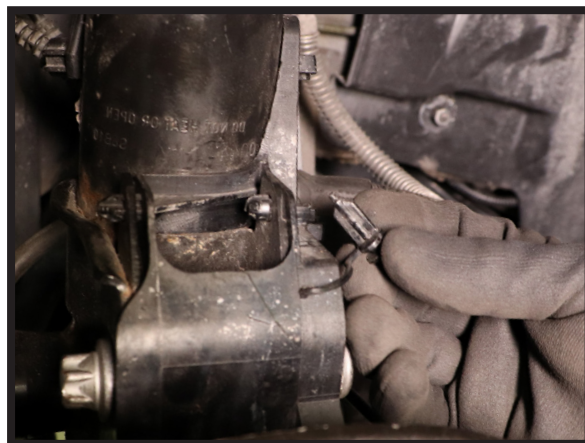

FIGURE 13



FIGURE 14

10. REMOVE THE SWAY ARM LINK NUT AND DISCONNECT THE SWAY ARM FROM THE STRUT. (FIGURES 15, 16)

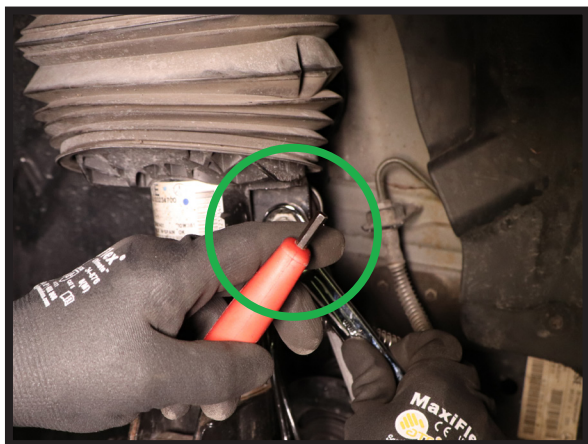

FIGURE 15



FIGURE 16

11. REMOVE THE TWO (2) STRUT BOTTOM MOUNT BOLTS. (FIGURES 17, 18, 19)



FIGURE 17

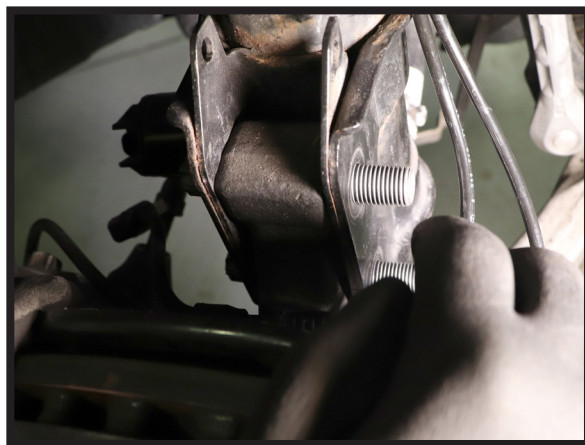

FIGURE 18



FIGURE 19



12. REMOVE THE AIR STRUT FROM THE VEHICLE. (FIGURE 20)



FIGURE 20

13. REMOVAL COMPLETE.

AIR STRUT INSTALLATION

-  *Tighten all nuts and bolts to manufacturer's specifications during the installation process.*
-  *Do not remove the air fitting from the air strut. Doing so may cause damage and/or void warranty. Remove the white shipping pin from the new air fitting and insert the air line until fully seated.*

1. INSTALL THE NEW ARNOTT STRUT INTO THE VEHICLE. (FIGURE 21)

NOTE: WHEN INSTALLING THE STRUT, MAKE SURE THE ELECTRICAL CONNECTIONS AND BRAKE LINES ARE ORIENTATED CORRECTLY TO AVOID ENTANGLEMENT WITH THE NEW STRUT.



FIGURE 21

2. REINSTALL THE THREE (3) TOP MOUNT BOLTS. TIGHTEN TO MANUFACTURER'S SPECIFICATIONS. (FIGURE 22)

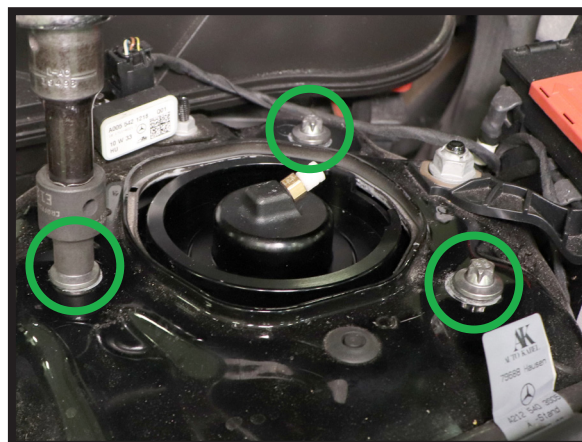

FIGURE 22

3. REINSTALL THE TWO BOTTOM MOUNT BOLT AND NUTS. TIGHTEN TO MANUFACTURER'S SPECIFICATIONS (FIGURES 23, 24)



FIGURE 23



FIGURE 24

4. REINSTALL THE SWAY ARM LINKAGE BOLT AND NUT. TIGHTEN TO MANUFACTURER'S SPECIFICATIONS. (FIGURES 25, 26)



FIGURE 25



FIGURE 26

5. REINSTALL THE STRUT WIRE MOUNTING BRACKET. (FIGURES 27, 28)



FIGURE 27



FIGURE 28

6. REROUTE AND RECLIP ELECTRICAL AND BRAKE LINES TO STRUT WIRE MOUNTING BRACKET. (FIGURE 29)



FIGURE 29

7. RECONNECT THE ELECTRICAL CONNECTION TO THE BOTTOM MOUNT OF THE NEW STRUT. (FIGURE 30)



FIGURE 30

8. REMOVE THE WHITE PLASTIC SHIPPING PIN FROM THE AIR LINE FITTING AND DISCARD. (FIGURE 31)

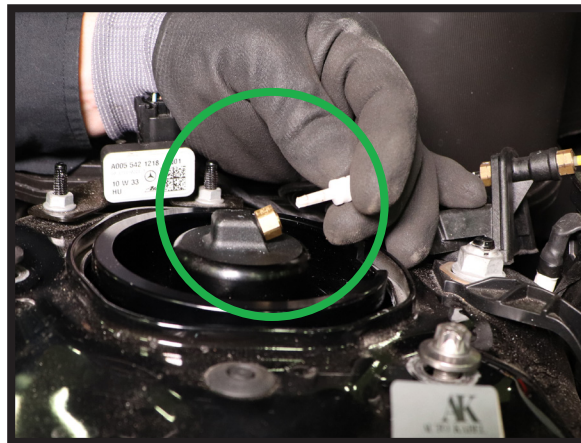
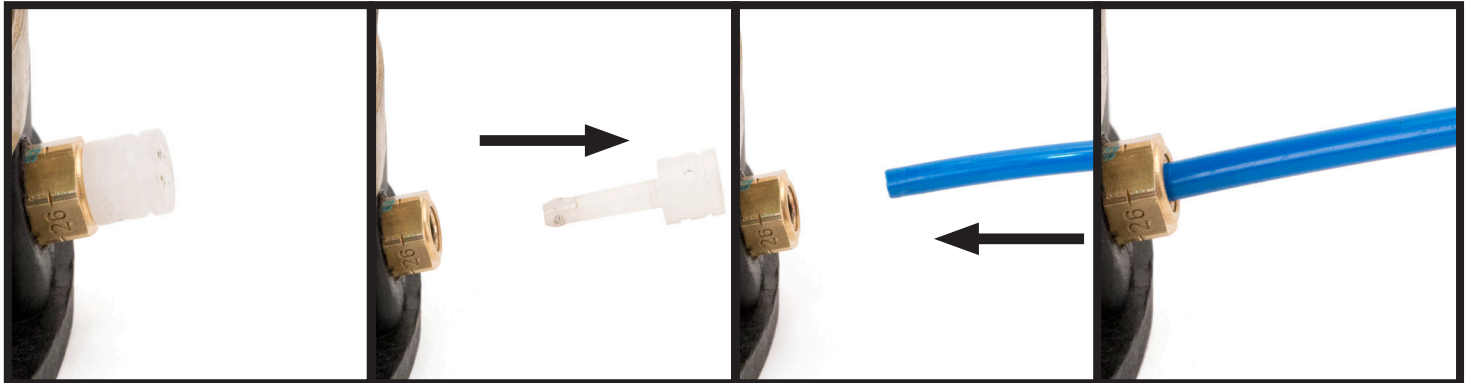

FIGURE 31

9. INSTALL THE AIR LINE INTO THE AIR LINE FITTING. (FIGURES 32, 33, 34)



AS RECEIVED

REMOVE & DISPOSE
OF SHIPPING PIN

INSERT THE AIR LINE
INTO THE FITTING AND
PRESS UNTIL FIRMLY
SEATED

WITH THE AIR LINE INSERTED,
PULL AIR LINE OUTWARD TO
LOCK AND ENSURE A SECURE
CONNECTION

FIGURE 32

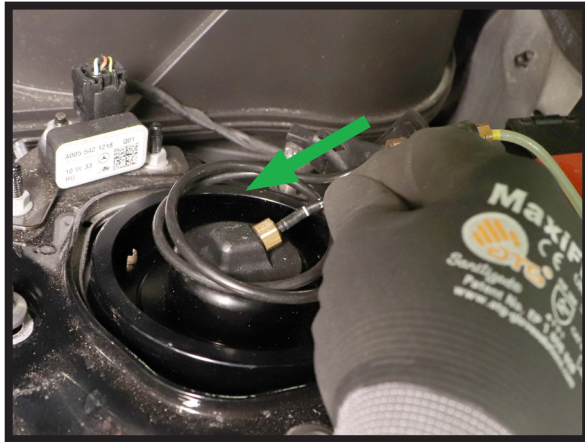

FIGURE 33



FIGURE 34

10. REINSTALL THE RIGHT FRONT WHEEL.
11. INFLATE AIR SYSTEM PER MANUFACTURER'S SPECIFICATIONS.
12. LOWER VEHICLE.
13. INSTALLATION COMPLETE.